

Number of SAP's of perimeter  $2n$  (offset 2) with the property that all the right-angles of the same orientation are contiguous (A342536)

1, 1, 3, 4, 10, 17, 36, 65, 126, 227, 419, 743, 1323, 2295, 3965

Perimeter 4:



Perimeter 6:



Perimeter 8:

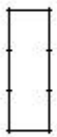

Perimeter 10:

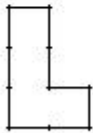
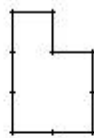
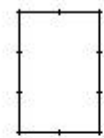

Perimeter 12:

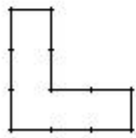
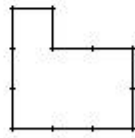
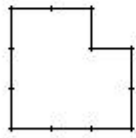
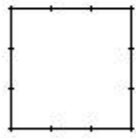
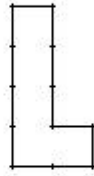
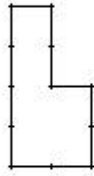
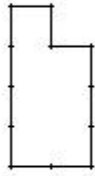
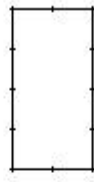
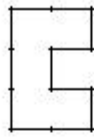
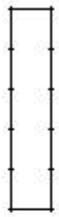

Perimeter 14:

